

FURNACE CREEK

Lat. 36°15'  
 Long. 116°45'

CALIFORNIA 324

C&GS 36 116 3

- |     |             |      |        |
|-----|-------------|------|--------|
| (1) | L.F. Biggs  | 1907 | A 6668 |
| (2) | "           | "    | "      |
| (3) | G.W. Moore  | 1937 | B 7246 |
| (4) | "           | "    | "      |
| (5) | J.O. Durbin | 1950 | PV 82  |

Nevada 47  
 346

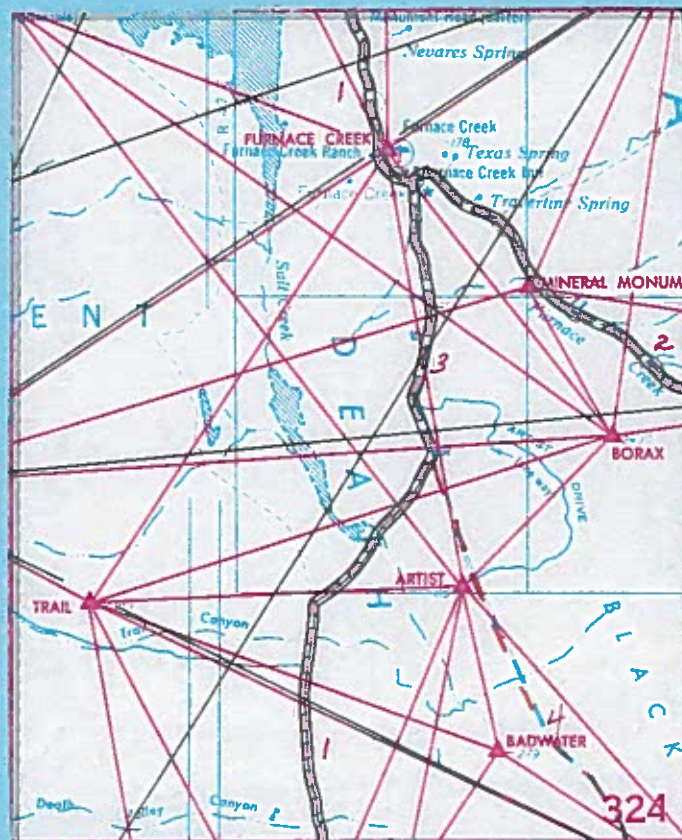

301

324

FURNACE CREEK (324)

California

L.F. Biggs, 1907

Third Order

Adjusted Elevations Based  
On Sea Level Datum of 1929

Book: A 6668

Latitude 36°15' Longitude 116°45'

FILE COPY

- (1) FROM BENNETT'S WELL QUADRANGLE (301) NORTH THROUGH DEATH VALLEY  
TO STATE LINE NEAR DAYLIGHT SPRINGS THENCE INTO CHLORIDE CLIFF  
QUADRANGLE (346)

Bennett's Well, 7 mi N. of; 20 ft E. of rd.; iron post stamped  
"B 1907 -253" (Not recovered) \*-244.853

Bennett's Well, 10.1 mi N. of, 20 ft E. of rd.; iron post  
stamped "B 1907 -263" (Not recovered) -254.351

Furnace Creek Ranch, 8.6 mi S. of; 20 ft E. of rd., in borax  
flat; iron post stamped "B 1907 -284" Not Found '83 -275.133

Furnace Creek Ranch, 5.9 mi S. of; 20 ft E. of rd.; iron post  
stamped "B 1907 -223" Not Found '83 -224.129

Furnace Creek Ranch, 2.8 mi S. of; 20 ft W. of rd.; iron post  
stamped "B 1907 -227" OK '83 -218.558

Furnace Creek Ranch, at; 300 ft S. of house, at rd. fk.; iron  
post stamped "B 1907 -178" (NOS Quad 36 116 3 Line 101) OK '83 -179.343  
230 yards west of centerline of State Highway 190.  
6 feet south of woven fence wire, in line with row of trees  
directly behind registration office. (up-dated description from  
NGS text)

\*=Elevations having the minus sign are below sea level.

2/10/55

Retyped 4/15/71 blm *sp*

FURNACE CREEK (324)

California

L.F. Biggs, 1907

Third Order

Adjusted Elevations Based  
On Sea Level Datum of 1929

Book: A 6668

Latitude 36°15' Longitude 116°45'

FILE COPY

(2) FROM RYAN QUADRANGLE (323) WEST TO FURNACE CREEK RANCH

Note: This line was run by Third Order methods but closure was 0.583 ft high in a distance of 11.6 mi. This closure error has been prorated in the line.

Smith Tank, 2.1 mi W. of; 8.1 mi E. of Furnace Creek; 30 ft  
S. of rd.; in boulder; aluminum tablet stamped "B 1907 1330"

Not Found '83  
1329.761

Furnace Creek, 2.5 mi E. of; at spring (head of Furnace Creek),  
40 ft N. of rd.; iron post stamped "B 1907 283"

Not Found '83  
282.300

2/10/55

Retyped 4/15/71 blm *af*

FURNACE CREEK (324)

California

G.W. Moore, 1937

Third Order

Adjusted Elevations Based  
On Sea Level Datum of 1929

Book: B 7246

Latitude 36°15' Longitude 116°45'

FILE COPY

- (3) FROM POINT 2.8 MILES SOUTH OF FURNACE CREEK RANCH, SOUTH 3.1 MILES  
ALONG OLD ROUTE TO OLD BENCH MARK "B 73 1907"

Furnace Creek Ranch, 2.8 mi S. of; 0.3 mi W. of hwy.; at Golden  
Canyon Rd. fk.; 200 ft SE. of iron post "B 74 1907 -277",  
40 ft W. of an old rd.; painted white, top of steel rod -217.48

Mushroom Rock, 1.6 mi N. of; at top of hill; 31 ft W. of rd.,  
painted white, top of a steel rod -180.22

Mushroom Rock, 0.4 mi N. of; 4.9 mi S. of Furnace Creek Ranch;  
40 ft W. of rd.; painted white, top of steel rod -231.46

Mushroom Rock, 0.6 mi S. of; 5.9 mi S. of Furnace Creek Ranch;  
at top of hill; 100 ft S. of USGS iron post "-233 B 73 1907",  
24 ft E. of rd.; painted white, top of steel rod -226.07

FURNACE CREEK (324)

California

G.W. Moore, 1937

Third Order

Adjusted Elevations Based  
On Sea Level Datum of 1929

Book: B 7246

Latitude 36°15' Longitude 116°45'

FILE COPY

(4) FROM NEAR MUSHROOM ROCK SOUTHEAST ALONG ROAD TO BAD WATER

Furnace Creek Ranch, 6.8 mi S. of; 36 ft E. of rd.; set on conc. post; USDINPS tablet stamped "R.P.P.O.T. 571 + 02.95" ELEVATION -71.08" *OK-83* -71.092

Furnace Creek Ranch, 7.0 mi S. of; 55 ft NE. of intersection of hwy. SW. to Bennett's Well, 40 ft E. of hwy.; set on conc. post; standard tablet stamped "GWM 24 1937 71" (Not found, 1950) *Not Found '83* -70.963

Furnace Creek Ranch, 7.9 mi S. of; 46 ft E. of hwy.; set on conc. post; NPS tablet stamped "R.P.P.O.T. 515 + 62.62" ELEVATION -177.32 *OK-83* -177.314

Furnace Creek Ranch, 8.5 mi S. of; 53 ft E. of hwy., set on conc. post; NPS tablet stamped "R.P.P.O.T. 483 + 90.90" ELEVATION -203.81 *OK-83* -203.804

Furnace Creek Ranch, 9.4 mi S. of; at top of hill; 20 ft SW. of hwy.; set on conc. post; NPS tablet stamped "P I 439 + 17.48" ELEVATION -152.08 (Destroyed, 1950) *Not Found '83* -152.074

Furnace Creek Ranch, 9.6 mi S. of; at top of hill, opposite exit of one-way rd.; 40 ft SW. of hwy., set on conc. post; standard tablet stamped "GWM 25 1937 -163" *OK-83* -162.851

Furnace Creek Ranch, 9.7 mi S. of; at highest point on hill; 30 ft NE. of hwy.; set on conc. post; NPS tablet stamped "R.P.P.O.T. 422 + 79.82" ELEVATION -159.76" *Not Found '83* -159.751

Furnace Creek Ranch, 10.1 mi S. of; near foot of hill; 35 ft NE. of hwy.; set on conc. post; NPS tablet stamped "-200.77 R.P.P.O.T. 399 + 88.59" *Not Found '83* -200.760

Furnace Creek Ranch, 10.7 mi S. of; 45 ft NE. of rd.; set on conc. post; NPS tablet stamped "R.P.P.O.T. 367 + 64.40 ELEV -173.00" *OK-83* -172.991

Furnace Creek Ranch, 11.2 mi S. of; at top of hill; 40 ft NE. of hwy.; set on conc. post; NPS tablet stamped "R.P.P.O.T. 348 + 38.83" ELEV -165.33" (Not found 1950) *Not Found '83* -165.320

FURNACE CREEK (324)

California

G.W. Moore, 1937

Third Order

Adjusted Elevations Based  
On Sea Level Datum of 1929

FILE COPY

Book: B 7246

- (4) Furnace Creek Ranch, 12.0 mi S. of; 82 ft SE. of intersection of T-rd. SE. to Salt Pools, 24 ft NE. of hwy.; in boulder; standard tablet stamped "GWM 26 1937 197" (Not found 1950) *Destroyed '83* -196.610
- Furnace Creek Ranch, 12.1 mi SE. of; 460 ft SE. of Salt Pools Rd. fk., 45 ft NE. of hwy.; set on conc. post; NPS tablet stamped "R.P.P.O.T. 295 + 35.05 -194.96" (Not found 1950) *Not Found '83* -194.934
- Furnace Creek Ranch, 12.4 mi S. of; 44 ft NE. of hwy.; set on conc. post; NPS tablet stamped "R.P.P.O.T. 275 + 35.38 -225.89" *OK-'83* -225.865
- Furnace Creek Ranch, 13.0 mi S. of; at foot of hill; 50 ft NE. of hwy.; set on conc. post; NPS tablet stamped "R.P.P.O.T. 247 + 58.87 -256.90" *Not Found '83* -256.870
- Furnace Creek Ranch, 13.4 mi S. of; at top of hill; 44 ft NE. of hwy.; set on conc. post; NPS tablet stamped "R.P.P.O.T. 225 + 19.83 -202.10" *OK-'83* -202.076
- Furnace Creek Ranch, 14.0 mi S. of; at Natural Bridge Rd. fk. E.; 45 ft SW. of hwy.; set on conc. post; standard tablet stamped "GWM 27 1937 -241" (Reset by L.R. Curtis, 1954) *Not Found '83* -236.954
- Furnace Creek Ranch, 14.06 mi S. of, along Bad Water Rd. to the Natural Bridge Rd. fk.; 3.5 mi N. of Bad Water; 36 ft NE. of and 4 ft higher than center of rd., 23 ft E. of signpost; in conc. post; standard tablet stamped "1 LC 1954 237" *OK-'83* -236.954
- Reference mark, 100 ft SE. of tablet; 48 ft SW. of hwy., painted white, steel rod -243.232
- Furnace Creek Ranch, 14.6 mi S. of; 40 ft NE. of hwy.; set on conc. post; NPS tablet stamped "R.P.P.O.T. 158 + 41.08 -248.28" *OK-'83* -248.280
- Furnace Creek Ranch, 15.4 mi S. of; at top of hill; 40 ft E. of hwy.; in conc. post; NPS tablet stamped "R.P.P.O.T. 119 + 6250 ELEV -209.50" *OK-'83* -209.471
- Furnace Creek Ranch, 15.7 mi S. of; on small rise, at foot of hill; 30 ft E. of hwy.; set on conc. post; standard tablet stamped "GWM 28 1937 256" (Not found 1950) *Not Found '83* -256.378
- Reference mark, 92 ft S. of tablet; 26 ft E. of rd.; painted white, top of steel rod -257.37

FURNACE CREEK (324)

California

J.C. Durbin, 1950

Third Order

Adjusted Elevations Based  
On Sea Level Datum of 1929

Book: PV 82

Latitude 36°15' Longitude 116°45'

FILE COPY

(5) DOUBLE RUN SPUR LINE TO USGS TRIANGULATION STATION ARTIST 1949

Mushroom Rock, USGS standard tablet stamped "GWM 25 113 1937" -162.851

ARTIST TRIANGULATION STATION (USGS):

Latitude 36°19'37.037" Longitude 116°50'00.936" (Adj. 1955) - 85.009 Adj.

Reference mark No. 1 - 87.231 "

Reference mark No. 2 - 87.493 "

8/26/55

Retyped 4/15/71 blm *SP*