

FILE COPY

36° 15'
116° 45'

CALIF. 324

346
47 NEV

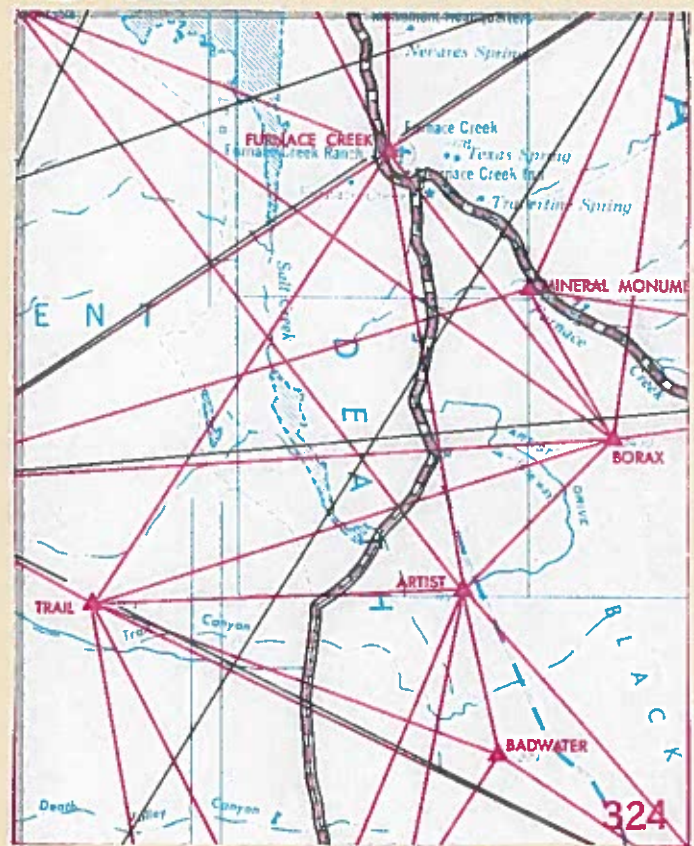

36° 15'

301

116° 45'

36°15'
116 45

CALIFORNIA

324

INDEX

| <u>Station</u> | <u>Project</u> |
|----------------------------|----------------|
| Artists | -- (M) |
| <i>Destroyed</i> -Badwater | -- (M) |
| Borax | -- (M) |
| Furnace Creek | -- (M) |
| Mineral Monument | -- (M) |
| Trail | -- (M) |

(M) = Multilith

X - U
Y

| | | | | | | | | |
|------------------|----|----|---------|-----|----|---------|------------|-----------|
| ARTISTS | 36 | 19 | 37.0370 | 116 | 50 | 9360 | 2638125.43 | 368911.64 |
| BADWATER | 36 | 16 | 41.2590 | 116 | 4 | | | |
| | 36 | 16 | 41.2590 | 116 | 49 | 13.3510 | 2642421.57 | 351229.66 |
| BORAX | 36 | 22 | 20.2850 | 116 | 46 | 39.8520 | 2654193.44 | 385790.82 |
| FURNACE CREEK | 36 | 27 | 27.9060 | 116 | 51 | 39.5940 | 2628994.10 | 416333.49 |
| MINERAL MONUMENT | 36 | 25 | 12.3080 | 116 | 48 | 40.8660 | 2643903.14 | 402954.15 |
| TRAIL | 36 | 19 | 21.8240 | 116 | 58 | 14.3970 | 2597788.78 | 366491.69 |

UNITED STATES
DEPARTMENT OF THE INTERIOR
GEOLOGICAL SURVEY

THIRD-ORDER TRIANGULATION
North American Datum of 1927

FURNACE CREEK QUADRANGLE
CALIFORNIA 324
N3615-W11645/15

FILE COPY

- Inyo County
Edition of 3/1/57
- Numbered lines indicate listed azimuths and distances to the following stations not on the quadrangle:
1. C&GS BM "W 680 1943"
 2. Bennett
 3. Agur (C&GS)
 4. Poison
 5. Trianglum
 6. Boundary (USGS) (C&GS)
 7. Echo(C&GS)
 8. Pyramid Peak (C&GS)
 9. Dante(USGS)(C&GS)

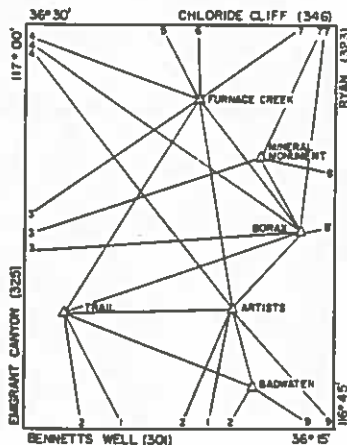

Books: PH 129-130

ARTISTS Inyo County CALIFORNIA

J. A. Lyon, 1949

Located about 11 mi. N. of Bennetts Well, 9 mi. S. of Furnace Creek Ranch on the highest part of a long low hill running E. and W.

Notes: Copied from C&GS reconnaissance description.

To reach from Furnace Creek Inn, drive 0.1 mi. westward to rd. intersection; take the rd. S. down Death Valley for 6.3 mi. to rd. forks; continue on pavement 3.8 mi. to T-rd. with low ridge to right (fork left "Artista Drive"); turn right off rd. and go onto the ridge from S. side; on ridge continue to near its SW. end to highest point and station.

Station mark: Standard tablet stamped "ARTISTS 1949" set in 6-in. concrete post.

Reference mark No. 1: Standard tablet stamped "1", set in small outcrop, 36.39 ft. from station mark in azimuth 60°50'. (Elevation -87.231)

Reference mark No. 2: Standard tablet stamped "2", set in small outcrop, 40.04 ft. from station mark in azimuth 153°36'. (Elevation -87.493)

Elevation -85.009 ft. (Spirit leveling by J. C. Durbin, 1950)

Latitude: 36°19'37.037" Longitude: 116°50'00.936"

| To Station | Azimuth | Back Azimuth | Feet |
|----------------------|--------------|--------------|----------|
| C&GS BM "W 680 1943" | 11°12'48.8" | 191°11'26.8" | 58,479.1 |
| Bennett | 22 50 20.9 | 202 46 51.7 | 74,782.1 |
| Trail | 87 51 31.8 | 267 46 39.5 | 40,411.0 |
| Poison | 14 10 34.3 | 322 04 37.3 | 80,077.8 |
| Furnace Creek | 170 23 35.5 | 350 22 37.0 | 48,295.4 |
| Borax | 224 52 56.1 | 44 54 55.2 | 23,305.4 |
| Dante(USGS)(C&GS) | 318 43 00.2 | 138 46 52.4 | 48,725.2 |
| Badwater | 34 7 38 10.1 | 167 38 38.2 | 18,197.2 |

BADWATER **Destroyed** Inyo County CALIFORNIA

J. T. Long, 1949

Located about 14 mi. S. of Furnace Creek Inn, in center of area known locally as "The Salt Pools".

To reach from Furnace Creek Inn, drive S. on paved rd. toward Badwater for 11.0 mi. to rd. forks and sign "SALT POOLS" pointing W.; take right fork toward Salt Pools for 1.95 mi. to NW. side of graded area at end of rd. and station.

Station mark: Standard tablet stamped "BADWATER 1949", set in cement block.

Elevation -279 ft. (By Plane table levels)

Latitude: 36°16'41.259" Longitude: 116°49'13.351"

| To Station | Azimuth | Back Azimuth | Feet |
|--------------------|-------------|--------------|----------|
| Bennett | 32°46'41.8" | 212°42'44.6" | 60,824.3 |
| Trail | 110 10 40.6 | 290 05 20.3 | 47,172.1 |
| Artists | 167 38 38.2 | 34 7 38 10.1 | 18,197.2 |
| Dante (USGS)(C&GS) | 303 42 19.2 | 123 45 43.0 | 33,957.2 |

BORAX Inyo County CALIFORNIA

J. T. Long, 1949

Located about 10 mi. N. of Badwater, 6 mi. SE. of Furnace Creek Ranch on the highest point of top.

Note: Description by C&GS reconnaissance notes. (USGS occupation via helicopter.)

To reach from Furnace Creek Inn, drive along State Highway 190 towards Death Valley Junction for 4.9 mi. to unpaved rd. going S. (This is the 20 Mule Team Scenic Loop); turn onto this unpaved rd. for 2.0 mi. to a building on a bench; at foot of pitch turn right off rd. into wash. Back up right-hand wash (old rd. goes up left one) for about 1 mi. to very large boulder in wash; continue up wash 200 yds. to a fork; take left fork of wash for 75 yds. to sharp rise of 50 ft. in height; go around this to left (ropes are needed for packs here) and continue in the same direction past a prominent shaft of clay; continue ahead to a tunnel in bank on left; at tunnel turn right up broad wash; continue ahead until canyon opens broadly and a long, steep slope can be seen on right; climb to top of this slope and from this point cross a sloping basin; climb to top of steep smooth slope and station. A 1 1/2-hour pack.

Station mark: Standard tablet stamped "BORAX 1949" set in solid rock, 0.4 ft. below surface of ground.

Reference mark No. 1: Standard reference mark tablet stamped "NO 1" set in rock outcrop, 35.69 ft. from station mark in azimuth 130°38'.

Reference mark No. 2: Standard reference mark tablet stamped "NO 2" set in rock outcrop, 37.22 ft. from station mark in azimuth 232°16'.

V.A. elevation 2430 ft.

Latitude: 36°22'20.285" Longitude: 116°46'39.852"

| To Station | Azimuth | Back Azimuth | Feet |
|---------------------|-------------|--------------|----------|
| Artists | 44°54'55.2" | 221°52'56.1" | 23,305.4 |
| Trail | 72 26 12.2 | 252 19 20.6 | 59,617.8 |
| Agur (C&GS) | 86 08 47.1 | 265 59 02.4 | 80,849.5 |
| Poison | 125 31 22.9 | 305 23 26.2 | 80,509.1 |
| Furnace Creek | 111 48 04.0 | 321 45 06.1 | 39,598.3 |
| Mineral Monument | 150 22 51.4 | 330 21 39.6 | 20,012.8 |
| Echo (C&GS) | 187 32 05.8 | 7 32 56.7 | 53,428.0 |
| Pyramid Peak (C&GS) | 261 41 33.7 | 81 47 29.4 | 49,550.7 |

FURNACE CREEK Inyo County CALIFORNIA

J. A. Lyon, 1949

Located at Furnace Creek Ranch Airport.

To reach, go to intersection of runways at N. corner of jct.

Station mark: Standard tablet stamped "FURNACE CREEK 1949" set in concrete post projecting about 6 inches above ground.

Reference mark No. 1: A 4-in. iron pipe set in concrete serving as windsock, 7.35 ft. from station mark in azimuth 7°38'.

Elevation -151 ft. (By Plane table leveling)

Latitude: 36°27'27.906" Longitude: 116°51'35.592"

| To Station | Azimuth | Back Azimuth | Feet |
|-----------------------|-------------|--------------|----------|
| Trail | 33°19'34.0" | 213°15'39.8" | 58,807.6 |
| Agur (C&GS) | 56 54 03.5 | 236 47 16.1 | 67,024.0 |
| Poison | 110 50 11.4 | 290 45 12.5 | 43,923.8 |
| Trianglum | 153 23 42.0 | 333 20 48.2 | 53,170.7 |
| Boundary(USGS) (C&GS) | 179 36 38.4 | 359 36 34.1 | 85,684.8 |
| Echo(C&GS) | 235 12 02.3 | 55 15 51.6 | 38,325.5 |
| Borax | 321 45 06.1 | 141 48 04.0 | 39,598.3 |
| Artists | 350 22 37.0 | 170 23 35.5 | 48,295.4 |

MINERAL MONUMENT Inyo County CALIFORNIA

A. E. Letey, 1949

Not Found '83

Located about 3.5 mi. SE. of Furnace Creek Ranch, in center of traffic circle on Zabriski Point.

To reach from Furnace Creek Ranch, drive SE. for 4.5 mi. toward Death Valley Junction on State Highway 190 to a sign reading "ZABRISKI POINT"; turn right and continue 0.2 mi. to station.

Station mark: A 3/4-in. brass rod and a brass plate set on top of a large concrete block in the center of a traffic circle.

Elevation 713 ft. (By Plane table leveling)

Latitude: 36°25'12.308" Longitude: 116°48'40.866"

Destroyed
See
Photo's

CAL. ZONE 4
X=2,628,994.1
Y=416,333.5

FILE COPY

Not Found '83

MINERAL MONUMENT (continued)

Latitude: 36°25'12.308" Longitude: 116°48'40.866"

| To Station | Azimuth | Back Azimuth | Feet |
|--------------------|-------------|--------------|----------|
| Aguer(C&GS) | 72°06'03.9" | 251°57'30.7" | 74,367.2 |
| Echo (C&GS) | 205 23 24.1 | 25 25 27.0 | 39,378.4 |
| Pyramid Peak(C&GS) | 279 50 15.3 | 99 57 23.0 | 59,804.6 |
| Borax | 330 21 39.6 | 150 22 51.4 | 20,012.8 |

TRAIL Inyo County CALIFORNIA

J. A. Lyon, 1949

Located 12 mi. NW. of Bennetts Well, 11 mi. SW. of Furnace Creek Ranch on highest part of top of low hill.

Note: Copied from C&GS reconnaissance description.

To reach from Furnace Creek Inn, drive 0.1 mi. westward to rd. intersection; take the rd. S. down Death Valley and continue 6.1 mi. to a main rd. intersection; turn right as via "Bennetts Well" and continue 5.4 mi. to rd. intersection; turn right off main rd. at sign "TRAIL CANYON"; continue on Trail Canyon Road for 5 mi. to a sag on bush on right side of rd. Station is across wash and about 1 mi. From end of truck travel pack across wash and up a side wash with a dull, gray rock on W. side and a brown material forming its E. sides. Keep to right slope going up wash and continue to highest point and station. A 45-minute pack.

Station mark: Standard tablet stamped "TRAIL 1949" set in bedrock.

Reference mark No. 1: Standard tablet stamped "1" set in bedrock 39.34 ft. from station mark in azimuth 276°16'.

Reference mark No. 2: Standard tablet stamped "2" set in bedrock, 25.41 ft. from station mark in azimuth 345°21'.

V.A. elevation 2389 ft.

Latitude: 36°19'21.824" Longitude: 116°58'14.397"

| To Station | Azimuth | Back Azimuth | Feet |
|--------------------------|--------------|--------------|----------|
| Furnace Creek | 213°15'39.8" | 33°19'34.0" | 58,807.6 |
| Borax | 252 19 20.6 | 72 26 12.2 | 59,617.8 |
| Artists | 267 46 39.5 | 87 51 31.8 | 40,411.0 |
| Badwater | 290 05 20.3 | 110 10 40.6 | 47,172.1 |
| C&GS E.M.W. 680 1943" | 332 28 15.7 | 152 31 45.4 | 62,937.7 |
| Bennett | 350 21 21.8 | 170 22 44.3 | 68,359.1 |

Calif 527



CH 117 527

